

L-XING DETAILS							
SL.NO	LC NO	CLASS	KM	M/AM/BLOCK	SEC	TELEPHONE CONNECTION WITH STN	INTERLOCKED/ NON INTERLOCKED
1.	58	C	46/23-25	M	NLD-RGD SILAO YARD	SILAO -63320-68891 13298 July 2023	NO INTERLOCKING PROPOSED

SL.NO	LC NO	CLASS	KM	M/AM/BLOCK	SEC	TELEPHONE CONNECTION WITH STN	TYUL	INTERLOCKED/ NON INTERLOCKED
1.	59	A	47/29-31	M	NLD-RGD SILAO YARD	SILAO	37950 (11/20)	NO INTERLOCKING PROPOSED


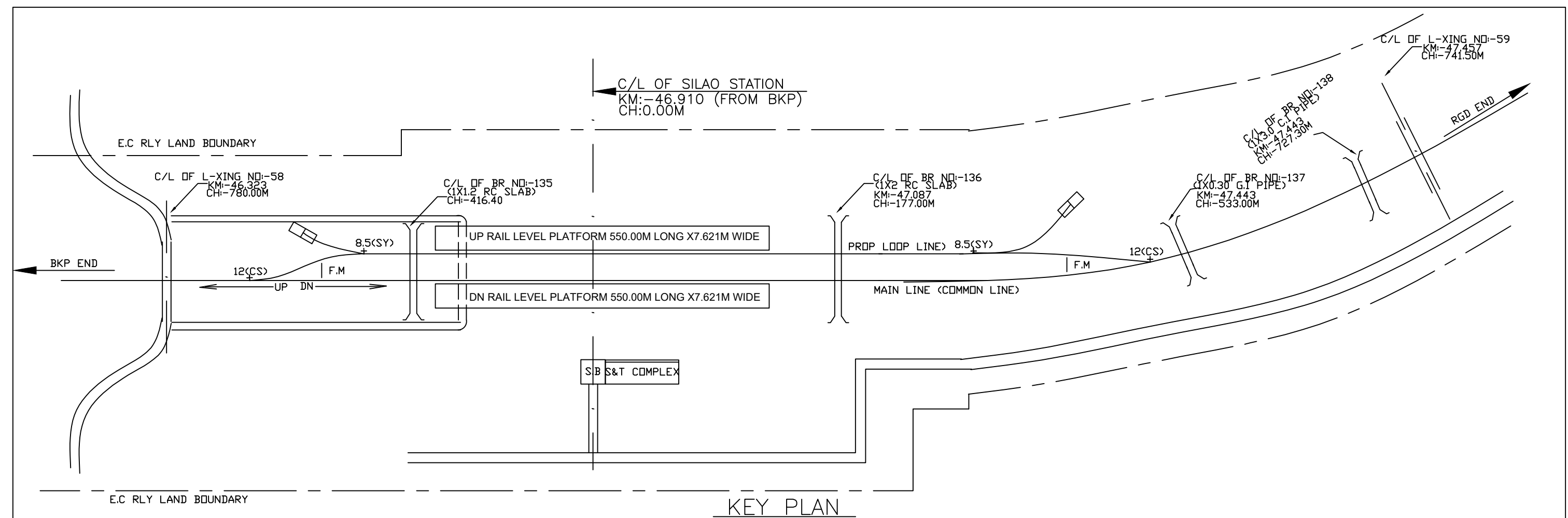
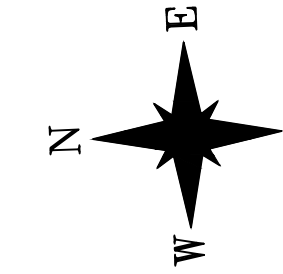

INFREINGEMENT DETAILS			
SL.NO	ITEM OF INFREINGEMENT	CH OF S.G.O./RPM	DETAILS OF INFREINGEMENT
1.	1 IN 12 TURN OUT EXISTS IN TRANSITION PORTION OF CURVE NO-14	VIOLATION OF RPM	1 IN 12 T/O AT CH= 510.50M AT ROD END 50.00M LONG PART OF 1 IN 12 TURNOUT IS IN TRANSITION PORTION OF CURVE NO-14.

- NOTES :-
- ALL THE DIMENSIONS ARE IN M. UNLESS OTHERWISE STATED.
  - ALL CHANGE TO BE TAKEN FROM C.I. OF STATION BUILDING.
  - ALL RAILS 60 KG. (NEW), PSC SLEEPER- 60 KG., BALLAST CUSHION - 350MM (W/L), 300 MM (L/L).
  - PASSENGER AMENITIES SHOULD BE PROVIDED AS PER RLY. BOARD'S GUIDELINES.
  - THIS PLAN IS BASED ON C.E.S. DRG. NO.-Y-81-2007, ALT-2 AND AS PER GROUND SURVEY.
  - THIS PLAN SUPERSEDES C.E.S. DRG. NO.-Y-81-2007, ALT-2.
  - SWITCHES ARE TERMED AS :-  
CS=CURVED SWITCH, SY=SYMMETRICAL SPLIT.
  - LAND BOUNDARY AS DRAWN/SHOWN IN THE PLAN HAS BEEN VERIFIED AT SITE WITH CERTIFIED/ORIGINAL LAND PLAN AVAILABLE IN HQ/DIVISION/ADEN OFFICE.
  - ALL 1 IN 12 TURN OUTS ARE CURVED SWITCHES.
  - TIN 8.5 TURN OUTS ARE SYMMETRICAL SPLIT.
  - GRADIENT DETAILS SHOWN HAVE BEEN VERIFIED AT SITE.
  - THERE ARE NO ANY INFREINGEMENT REGARDING TO RS&O.
  - THERE ARE NO CHANGE IN GRADIENT WITHIN 30M OF POINT ZONE AND NO NEW TURNOUT IS TAKING OFF FROM TRANSITION PORTION OF ANY CURVE.
  - NECESSARY RELAXATION TO BE OBTAINED FROM THE CTE FOR VIOLATION OF PARA 410 OF RPM 2000

AUTHORITY OF WORK:-

1) AS PER SR.DSTE/DNR LETTER NO.-SG/DRG/DNR, DATED-21.09.2021

2) PINK BOOK ITEM NO-67 OF 2021-22 AND PROJECT ID NO-03.01.16.03.1.50.001

LEGEND	
RAILWAY LAND BOUNDARY	---
EXISTING WORK	---
PROPOSED WORK	---
SIGNAL POST	---

C.E'S DRG NO.- Y - 50 - 2022

Signature block	
CPDE/ECR/HJP	
CTPM/ECR/HJP	NEERAJ AMBASTHA 2022.03.09 16:39:21+05'30'
DRM/DNR	Prabhat Kumar 2022.03.08 17:59:56 +05'30'
Sr.DEN/Co.DNR	SAURABH MISRA 2022.03.08 16:42:34 +05'30'
Sr.DDM/DNR	Md Inteyaz Alam 2022.03.08 15:57:25 +05'30'
Sr.DSTE/DNR	RAJESH KUMAR KUSHWAHA 2022.03.08 15:57:25 +05'30'
SR.DEE/TRD/DNR	RAMASHISH YADAV 2022.03.02 11:49:34 +05'30'
Sr.DEE/G/DNR	Gaurav Kumar 2022.03.08 15:53:31 +05'30'
SR.DEN/L/DNR	PANKAJ KUMAR 2022.02.28 08:39:35 +05'30'

EAST CENTRAL RAILWAY

DANAPUR DIVISION

(E' ROUTE)

SILAO STATION(SILO)

सिलाव स्टेशन

SILAO STN. YARD PLAN ALONG WITH INTERLOCKING OF L-XING GATE NO-58 & 59.

SCALE:- 1:1000

DRM DNR PLAN NO:- 12-2022

SHEET NO:-